

## ! IMPORTANT !

Please read assembly instructions prior to attempting installation

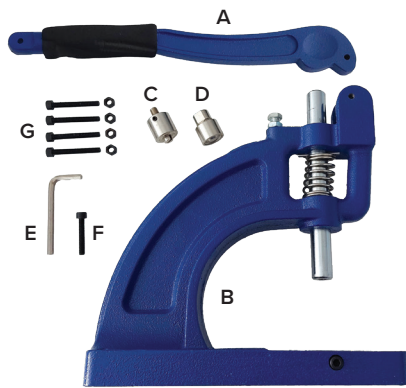

### Components

- A** Handle
- B** Main Body
- C** Top Die
- D** Bottom Die
- E** Hex Key
- F** M6 x 1.0 x 35mm Socket Cap Screw
- G** M6 x 1.0 x 45mm Socket Cap Screws & Nuts (4pcs of each)

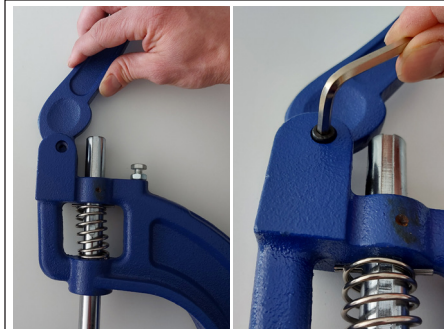

1. Attach the handle (A) to the main body (B) with the hex key (E) and socket cap screw (F).

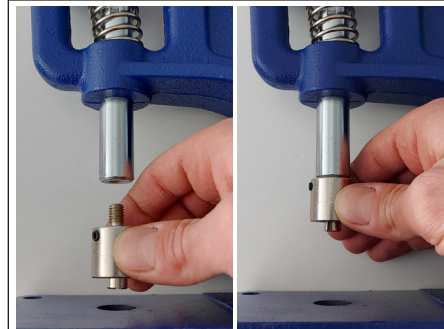

2. Thread the top die (C) into the main body (B). Tighten by hand only; **do not** use tools.

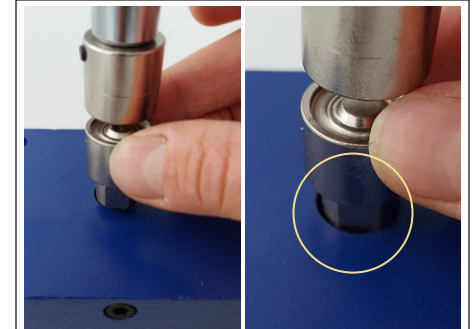

3. Place the bottom die (D) into the base (B). Ensure the flat sides of the bottom die (D) are facing towards the sides of the main body (B).

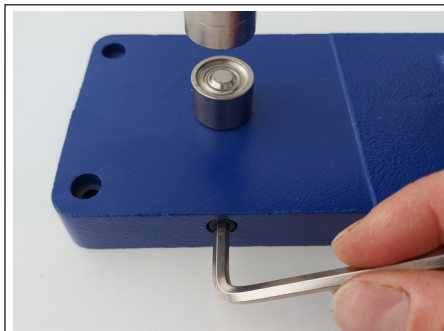

4. Secure the bottom die (D) into place. Slowly tighten the screws in the base of the main body (B) with the hex key (E).

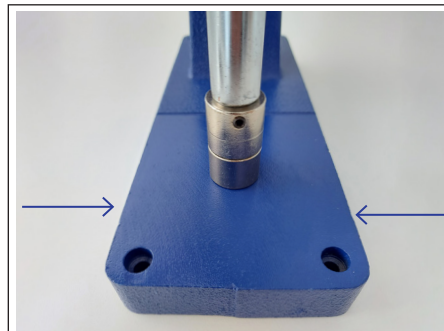

5. Adjust the bottom die (D) by loosening/tightening the two screws on either side of the base to re-position the bottom die (D) left or right, while adjusting it forwards and backwards as required.



6. Periodically pull down on the handle (A) to ensure the bottom die (D) is perfectly in line with the top die (C). **Repeat step 5 until the top and bottom are perfectly aligned.**



# Max-Press

## Assembly Instructions

### Installation

The **Max-Press** is easier to use when it is secured to a table or work surface.

\*Use the **Max-Press** as a guide to mark and drill four 1/4" holes.

\*Longer M6 x 1.0 socket cap screws & nuts may be required depending on work surface thickness.

\*Washers may also be required underneath work surface.

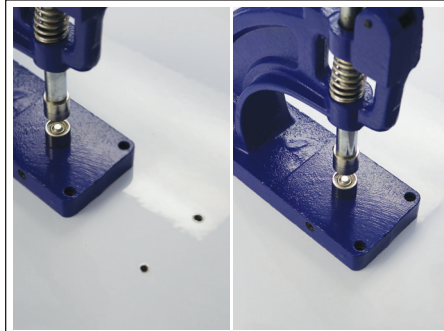

**1.** To fasten the **Max-Press** to a work surface, use the 4pcs socket cap screw and nuts (G) in each of the **four corners** of the main body (B).

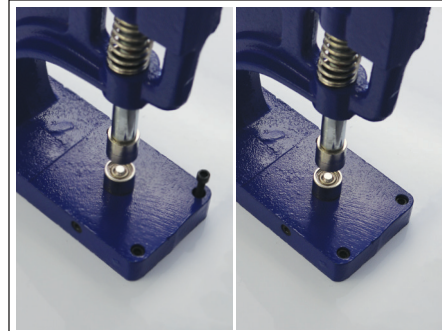

**2.** The heads of the socket cap screws (G) should sit in the holes of the main body (B) so that they are flush with the surface of the base.

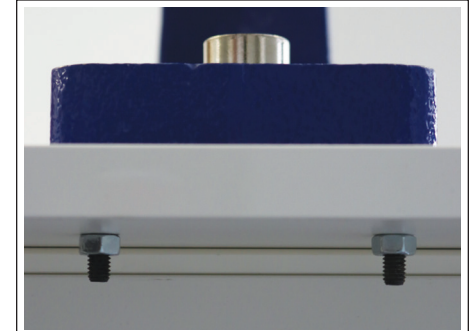

**3.** Thread the nuts onto the end of the four socket cap screws (G) under the work surface to secure the **Max-Press** in place.

### Operation

The Galaxy™ **Max-Press** is compatible with #2 grommets.

Galaxy™ **Max-Press** Grommets are:

- High-quality and self-piercing.
- Made from solid brass therefore they will not rust.
- Available in 3 finishes: brass, nickel, or black.
- 500 grommets are included per pack.

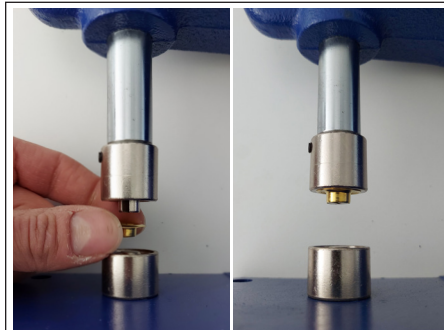

**1.** Push the top part of the grommet up onto the Top Die (C).

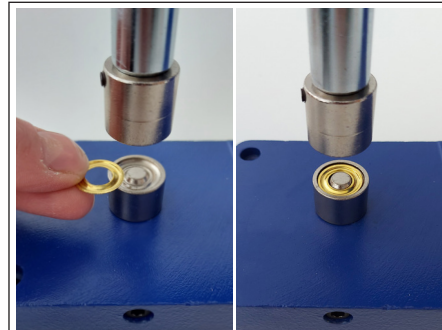

**2.** Place the bottom part of the grommet into the Bottom Die (D).

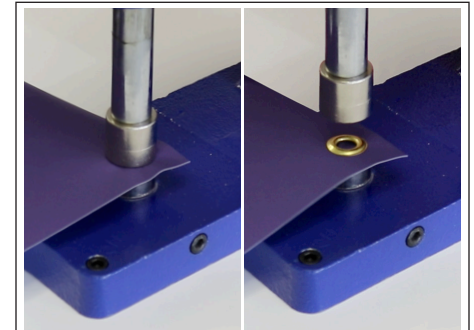

**3.** Insert media (print side up). Pull down on the handle (A) applying necessary pressure and voilà!