

ASSEMBLY INSTRUCTIONS

COMPONENTS:

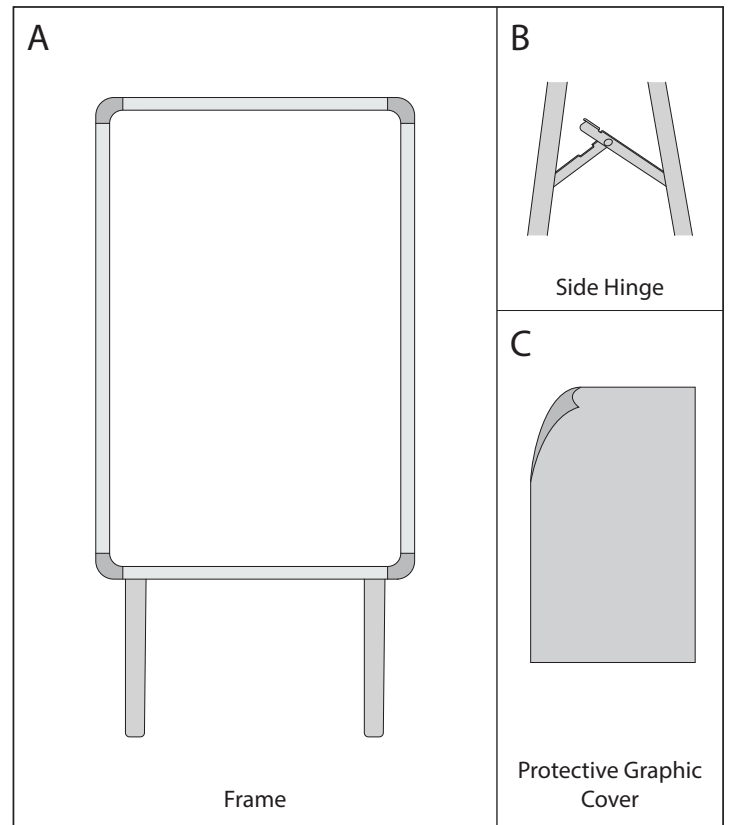

- 1** Stand a-frame upright and separate the front and back legs.

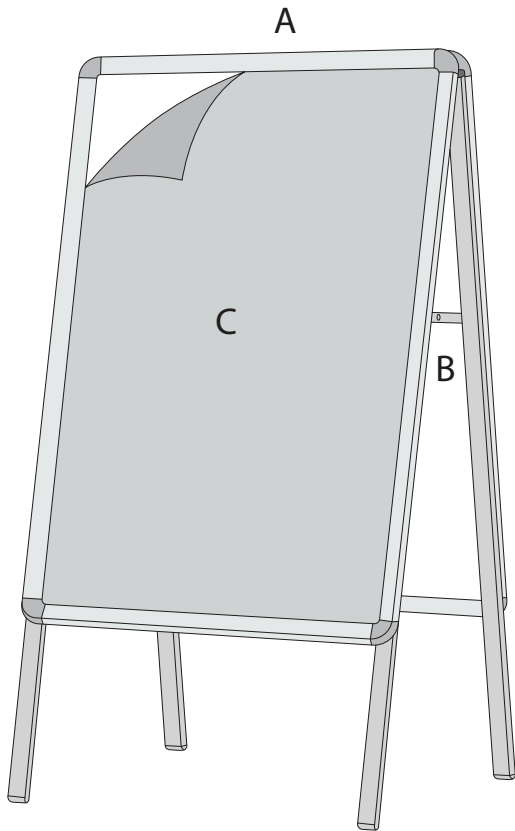
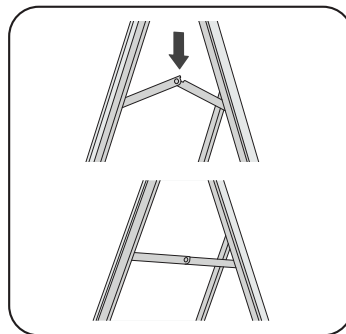

- 2** Push down the side hinges to lock into place.

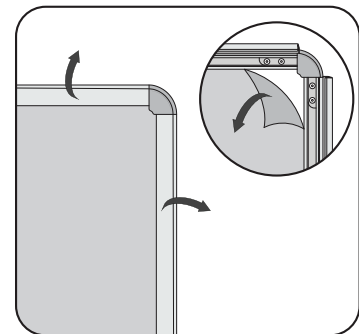

- 3** Open all four edges of the snap frame. Remove the clear protective cover.

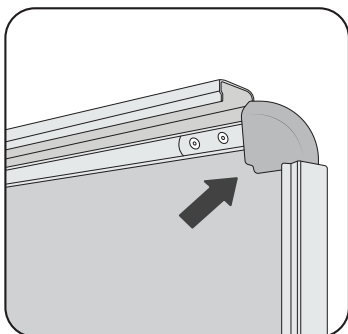

- 4** Slide the graphic in the frame, followed by the protective graphic cover.

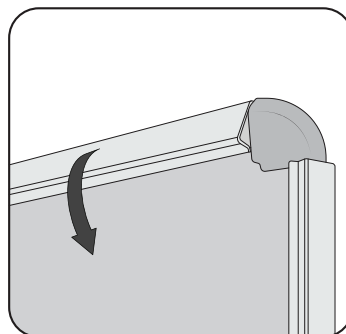

- 5** Snap the profile closed. Repeat on other side for additional graphics.