

Installation Instructions

V2-1124



CAUTION

Please read all instructions before attempting installation.

Components

- A Clamp top bar
- B Base
- C Support pole
- D Carry abg

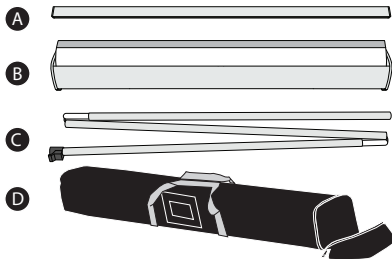

! For installation you will need: A trimmed banner + packing tape

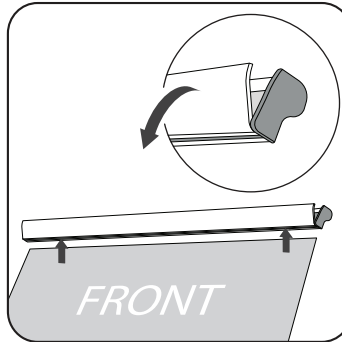

1 Open the top bar and fully insert the banner (front facing up).

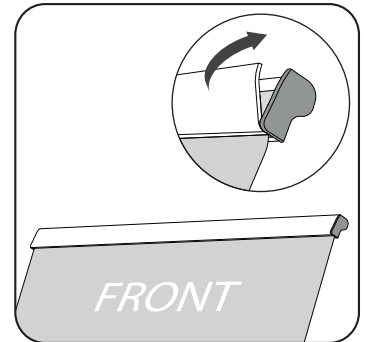

2 Press down firmly on clamp top bar to secure graphic into place.

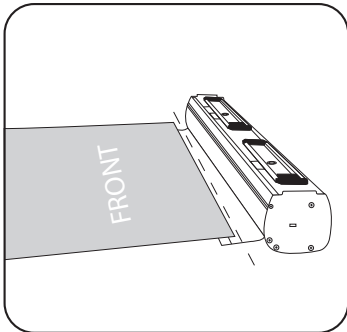

3 Peel the paper off the adhesive along the edge of the leader. Ensure the bottom of the banner is straight along the adhesive, and attach the banner (front facing up).

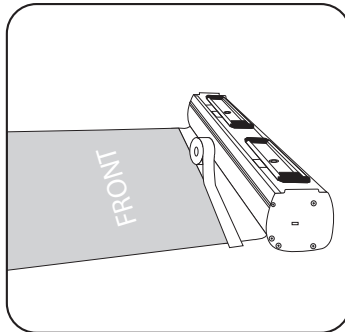

4 Secure the banner to the leader with additional tape on both sides.

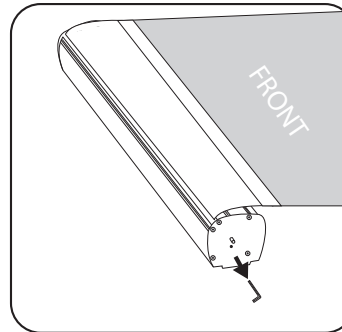

5 Gripping the banner securely with one hand, remove the locking pin from the right side of the base. Store the locking pin under the stand.

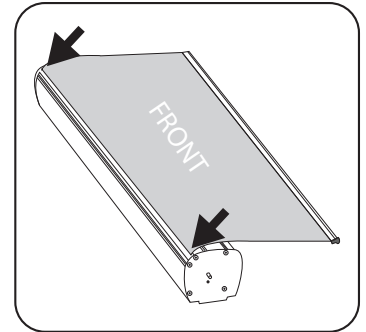

6 Carefully allow the banner to retract into the base, keeping it even distance from the edge of the base on both sides.



When installation is complete, leave lower portion of this sheet with the stand for the end user.

Set-up Steps

CAUTION: When disassembling the display, tilt the clamp top bar back on a slight angle and lift off the top off the pole. Then while holding the clamp top bar, carefully and slowly allow the banner to retract straight into the base, ensuring it does not wander over to either side while it is retracting.

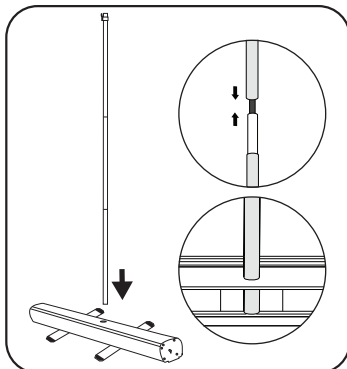

1 Twist out each support foot 90° and gently place the base on the ground. Insert the bottom of the pole in the center of the base.

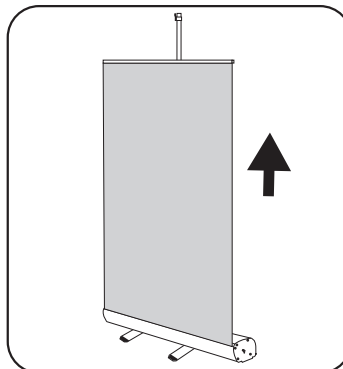

2 Standing behind the base, grab the top bar and pull the banner up to the top of the pole.

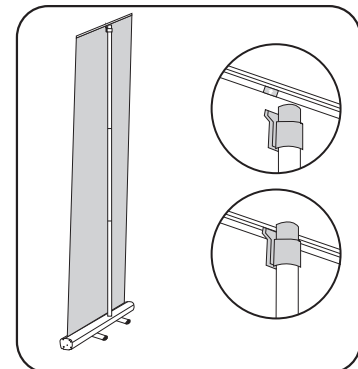

3 Tilt the clamp top bar back on a slight angle to position the fitting at the top of the pole into the channel in the center of the top bar.